

# Public Document Pack



**To: The Cathaoirleach and Each Member of Roscommon County Council**

**Date: Wednesday, 18 November 2020**

**Re: Notice of Monthly Meeting**

Dear Member,

Notice is hereby given that the Monthly Meeting of Roscommon County Council will be held in the **Council Chamber, Áras an Chontae, Roscommon on Monday, 23rd November, 2020 at 2.15 pm** to discuss the agenda set out below.

The Register of Chief Executive Orders will be available for inspection at the meeting.

You are hereby requested to attend.

Yours sincerely,

*Patricia Bohan*

Patricia Bohan  
Meetings Administrator

---

This meeting may be filmed for live or subsequent broadcast via the Council's website. At the start of the meeting the Cathaoirleach will confirm if all or part of the meeting is being filmed. You should be aware that the Council is subject to the Freedom of Information Act 2014 and the Data Protection Acts 1988 to 2018 and data collected during this webcast will be retained in accordance with legislation. Therefore by entering the Council Chamber and using the seats around the meeting tables, you are consenting to being filmed and to the possible use of those images and sound recordings for webcasting. Members of the public and press should confine themselves to the area provided so that their image is not captured on film.

---

## PAIDIR

## AGENDA

1. Adoption of Minutes
  - Minutes of Plenary Meeting held on 19.10.2020
  - Minutes of Special Meeting held on 12.11.2020
2. Matters Arising
3. Management Report
  - Management Report for October 2020
4. Disposal of Lands - Housing

- Rural Dwelling in Townland of Thomastown, Athlone, Co. Roscommon
- Rural Dwelling in Townland of Carrowgarve, Tibohine, Castlerea, Co. Roscommon
- Rural Dwelling in Townland of Cloghan, Mount Talbot, Co. Roscommon

5. 2020 Financial Review
6. Appointment of PPN Sectoral Nominee to Housing, ICT and Rural Water SPC
7. Chief Executive Business
8. Correspondence
9. Notices of Motion
  - 16.20 Award of Military Medals for Jadotville Siege - Cllr. Crosby
  - 17.20 TUS and CE Social Employment Schemes – Cllr Naughten
  - 18.20 Means Assessment of Carers Allowance – Cllr. Ward
  - 19.20 Medical Cards Eligibility – Cllr. Callaghan
10. Questions
  - 03.20 – Update on FSAI and LA Abattoir Inspections – Cllr. Callaghan
11. Councillors Conferences - Payments/Attendance
12. Votes of Congratulations and Sympathy
13. Any Other Business

Document is Restricted

This page is intentionally left blank

Document is Restricted

This page is intentionally left blank

Document is Restricted

This page is intentionally left blank



Document is Restricted

This page is intentionally left blank

Document is Restricted

This page is intentionally left blank

Document is Restricted

This page is intentionally left blank

Document is Restricted

This page is intentionally left blank



Document is Restricted

This page is intentionally left blank

583900 mE, 751270 mN

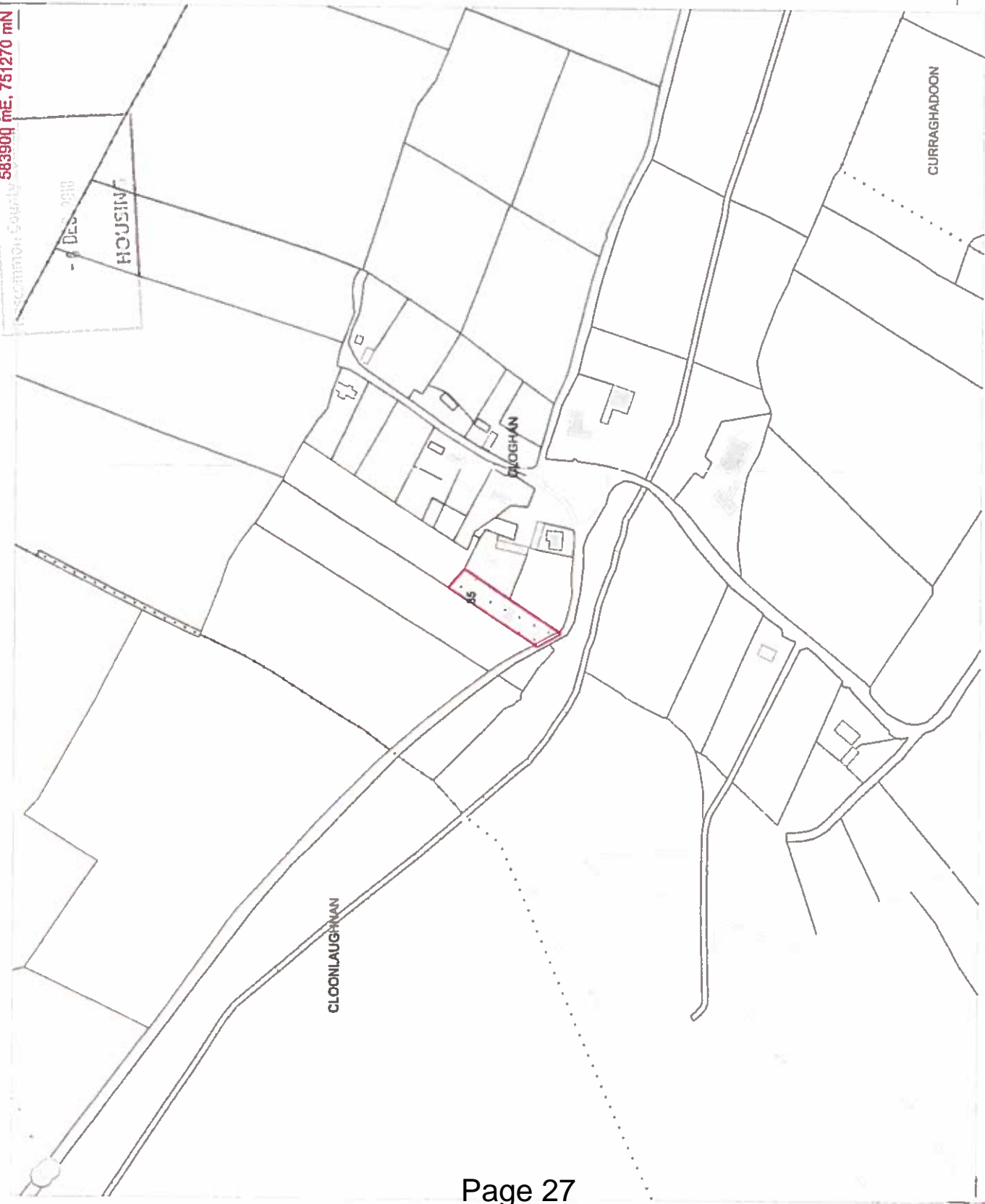

**The Property**  
**Registration Authority**  
**An tÚdaráis**  
**Clárúcháin Maoine**

Folio: RN42754F

This map should be read in conjunction with the folio.

Registry maps are based on OSI topographic mapping. Where registry maps are printed at a scale that is larger than the OSI published scale, accuracy is limited to that of the original OSI map scale.

For details of the terms of use and limitations as to scale, accuracy and other conditions relating to Land Registry maps, see [www.pral.ie](http://www.pral.ie)

This map incorporates Ordnance Survey Ireland (OSI) mapping data under a licence from OSI. Copyright © OSI and Government of Ireland.

(centre-line of parcel(s) edged)

Freehold

Leasehold

SubLeasehold

Burdens (may not all be represented on map)

Right of Way / Wayleave

Turbary

Pipeline

Well

Pump

Septic Tank

Soak Pit

A full list of burdens and their symbology can be found at:  
[www.landdirect.ie](http://www.landdirect.ie)

**The registry operates a non-conclusive boundary system. The Registry Map identifies properties not boundaries meaning neither the description of land in a register nor its identification by reference to a registry map is conclusive as to the boundaries or extent.** (see Section 85 of the Registration of Title Act, 1954). As inserted by Section 62 of the Registration of Deed and Title Act 2006.



1:2500 Scale

This page is intentionally left blank

Document is Restricted

This page is intentionally left blank

Document is Restricted

This page is intentionally left blank



Document is Restricted

This page is intentionally left blank

Document is Restricted

This page is intentionally left blank